

Package View

Surface Mount package packed per EIA/JEDEC Standard RS-481, IEC60286-3

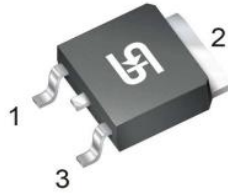

TO-252 (D-PAK)

Packing Quantity

Packing Type	Packing Code	Packaging Description	Reel (pc)	Inner Box (pc)	Carton (pc)	Carton Size (mm) (Max)
Reel	RO	16 mm Tape, 13" Diameter Plastic Reel	2,500	5,000	25,000	370x370x400

Component Orientation

Device Orientation and Direction of Feed

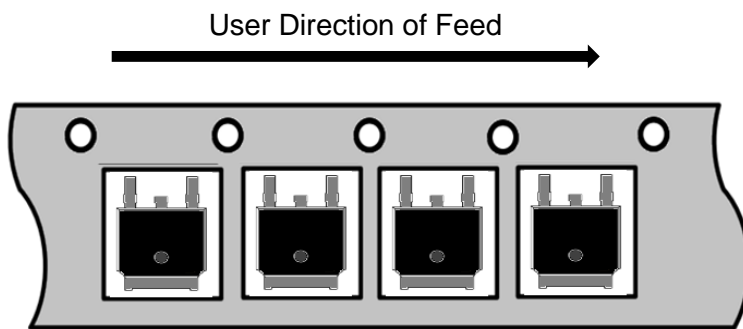

Component Lateral Movement

Maximum lateral movement for punched and embossed carrier

16 mm Tape

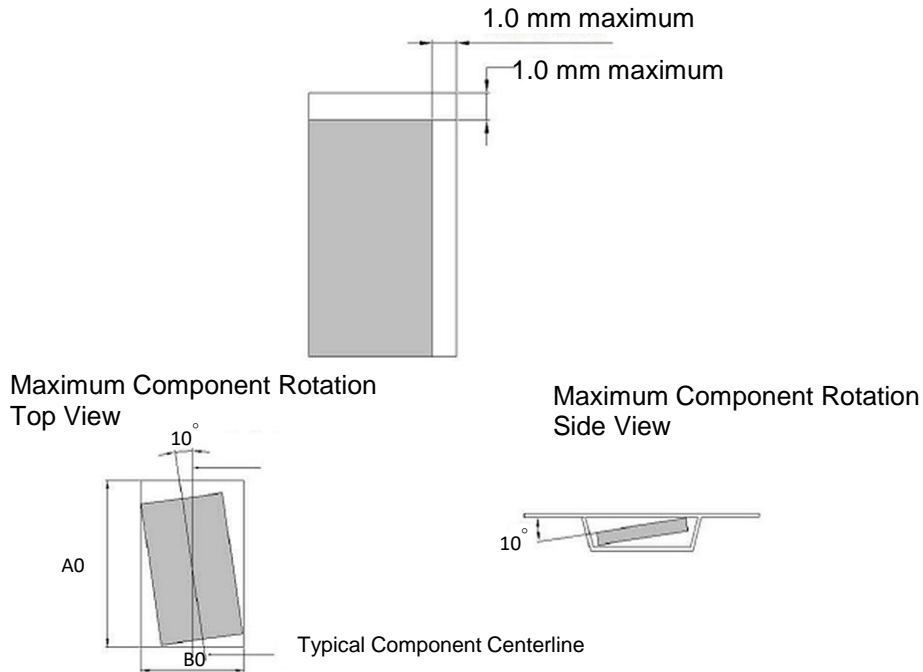

Tape leader & trailer

- Unfilled leader and trailer pockets are sealed
- Leaders and trailers are taped to tape and hub, respectively, with masking tape
- All materials are static-dissipative

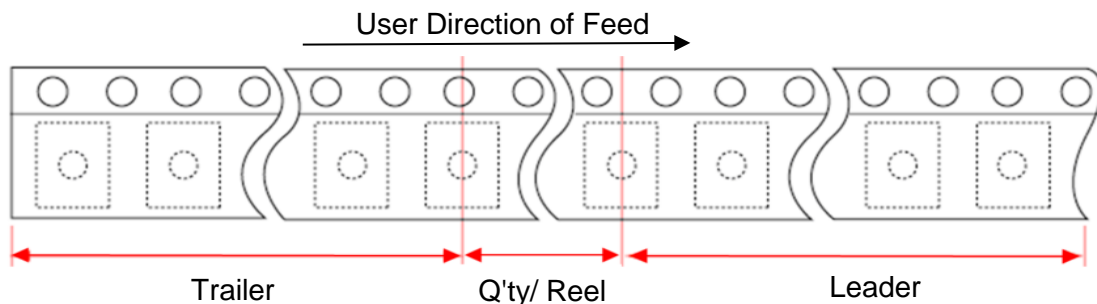

Trailer	Q'ty/Reel	Leader
Min 160 mm	2,500	Min 400 mm

Embossed Carrier Tape Specification

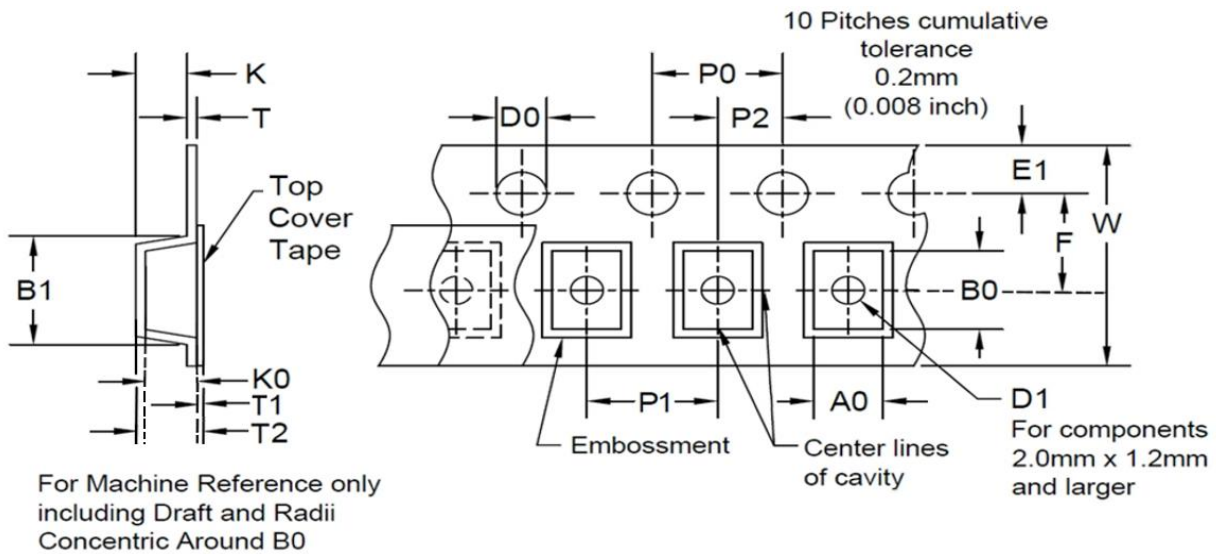

ALL DIMENSION IN MILLIMETERS(Unit : mm)

Dim	Tape size	D0	E1	P0	P2	T	Ao	Bo	Ko
Spec	16mm	1.50 +0.1/-0	1.75 ±0.10	4.00 ±0.10	2.00 ±0.10	0.3 ±0.05	6.9 ±0.10	10.5 ±0.10	2.7 +0.2/-0.15

Dim	Tape size	B1	D1	F	W	P1	K	T1	T2
Spec	16mm	-	1.50 +0.25/-0	7.5 ±0.10	16.00 +0.3/-0.2	8.0 ±0.10	-	-	-

Reel Specification

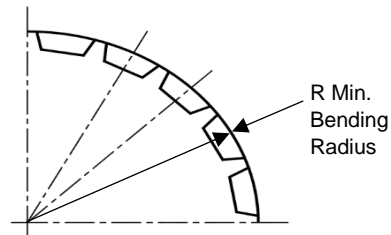
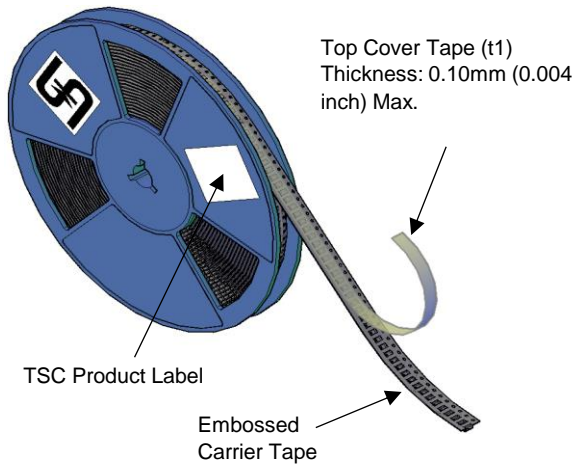

Tape with components shall pass around bending radius without damage, for reels with hub diameters. approaching minimum dimension.

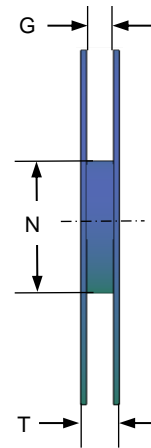
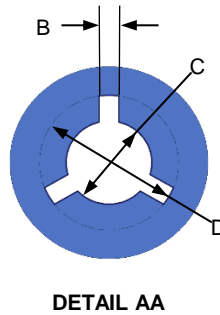
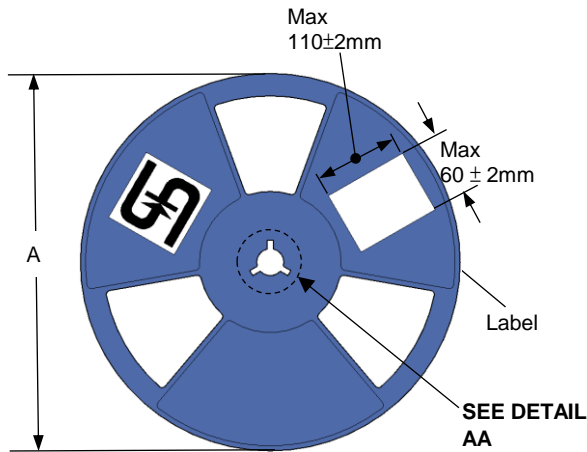

ALL DIMENSION IN MILLIMETERS (Unit : mm)

Reel Size	Tape size	A	B	C	D	N	G	T	
13"	16mm	330 ±2	2.0 +0.5/-0.2	13.0 +0.5/-0.2	-	100±2	16.4 +2.0/-0.0	22.4 max	

Note1: Surface Resistance $10^4 \sim 10^{11} \Omega$.